

Swivel castor with wheel brake 541

11x30 75 PEL

Furniture Castors Series 540 ST - Wheel PEL

-20 °C - +60 °C

+++
swivels easily

++
wear resistant

++
shock proof

++
floor protective

++
weather proof

Wheel

Casted high quality nylon wheel, blackelectrically conductive
<10⁴Ω

Zinc-die-cast housing - chrome plated
Swivel bearing with combined
plain-ball bearing
Wheel brake - glass fibre reinforced
Wheel axle revited

Swivel castor with wheel brake Wheel-Ø A x width B mm: 75x13+13

Load Capacity kg: 60

Load capacity tested according to EN 12530 and EN 12527

Overall height H mm: 93

Stern mm: 11x30

Swivel radius SR mm: 88

Wheel bearing: Nylon plain bearing

Advantages

- ✓ electrically conductive
- ✓ easy running on smooth floors
- ✓ impact proof
- ✓ high abrasion resistance
- ✓ easy to clean
- ✓ high chemical resistance

©Copyright 2024 Rollenbau GmbH, www.rollenbau.at 20.05.2024

ROLLENBAU

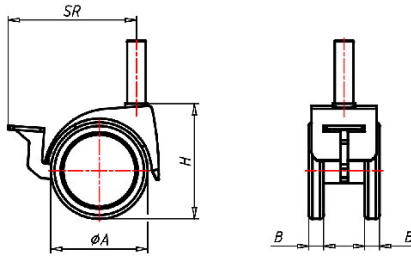

Applications

- Health-Professionals